

LC Standard Adapter Specification

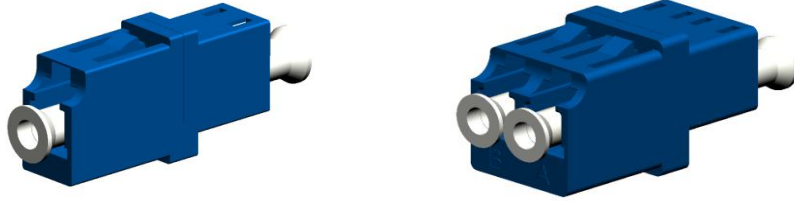

Application:

1. Telecommunication Network
2. CATV Network
3. Data Center
4. Testing
5. Optic Networks

Features:

1. High size precision
2. Compact design
3. High precision alignment with zirconia sleeve
4. IEC-61754-20/GR326/UL94-V0/ROHS/REACH compliance

Parameter:

Item NO.	Description	Unit	Standard
1	Insertion Loss(dB)	dB	≤ 0.2 dB
2	Repetitiveness(dB)	dB	≤ 0.1 dB
3	Interchangeability (dB)	dB	≤ 0.2 dB
4	Plug times	Times	200 times
5	Tensile strength	G	200-600G
6	Operating temperature	Celsius	-40~+85 Celsius
7	Storage temperature	Celsius	-40~+110 Celsius
8	Humidity	Celsius	95%RH (Non-Packaging)

LC Standard Adapter Specification

Specification & Order Code:

Code	Type	Color	Sleeve Type
E22	1 Simlex	1 Blue	1 Zirconia
	2 Duplex	2 Green	
		3 Aqua	
		4 Beige	
		5 Black	
		6 Heather Violet	
		7 Other custom color	

Order Code Example:E22111

Drawing:

Simplex

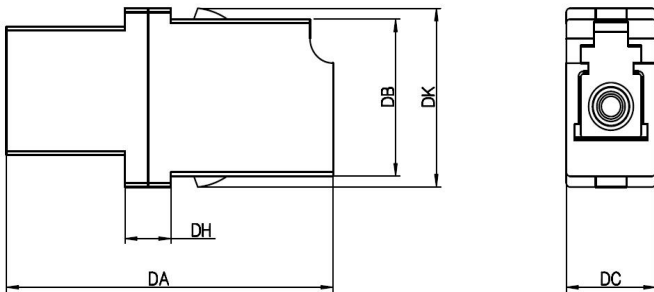

Duplex

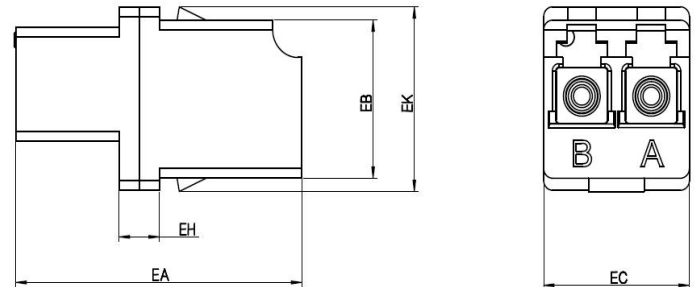

Ref.	Dimensional Tolerance	
	Min	Max
DA	25.5	27.5
DH	/	3.8
DB	11.5	11.6
DK	13	13.4
DC	6.9	7.0

Ref.	Dimensional Tolerance	
	Min	Max
EA	25.5	27.5
EH	-	3.8
EB	13	13.15
EK	14.5	15.3
EC	13	13.15

Packing:

Inner packing: 25 pcs/Tray

Outer packing: 1500 pcs/Carton

Carton size: 47*30*31mm

Noted:Packing can be customized for you.