

LC Duplex Adapter(SC Type) Specification

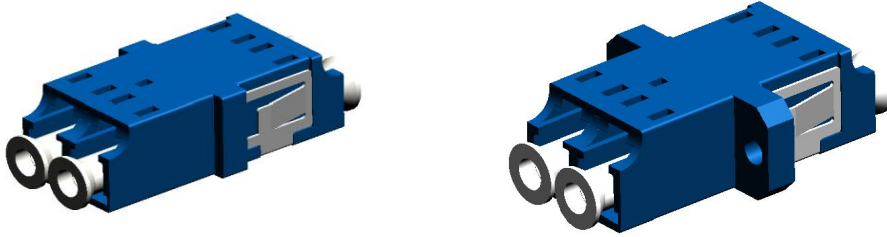

Application:

1. Telecommunication Network
2. CATV Network
3. Testing/Measurement Instruments Fiber To the Home
4. Data Center cabling

Features:

1. SC Type design allows use the LC Adapter in the SC panel and double the density
2. With flange and without flange available
3. High precision alignment with zirconia sleeve
4. IEC-61754-20/GR326/UL94-V0/ROHS/REACH compliance

Parameter:

Item NO.	Description	Unit	Standard
1	Insertion Loss(dB)	dB	≤ 0.2 dB
2	Repetitiveness(dB)	dB	≤ 0.1 dB
3	Interchangeability (dB)	dB	≤ 0.2 dB
4	Plug times	Times	200 times
5	Tensile strength	G	200-600G
6	Operating temperature	Celsius	-40~+85 Celsius
7	Storage temperature	Celsius	-40~+110 Celsius
8	Humidity	Celsius	95%RH (Non-Packaging)

LC Standard Adapter With Flange Specificati

Specification & Order Code:

Code	Type	Color	Sleeve Type
D22	1 With flange	1 Blue	1 Zirconia
	2 Without flange	2 Green	
		3 Aqua	
		4 Beige	
		5 Black	
		6 Heather Violet	
		7 Other custom color	

Order Code Example:D22111

Drawing:

Without Flange

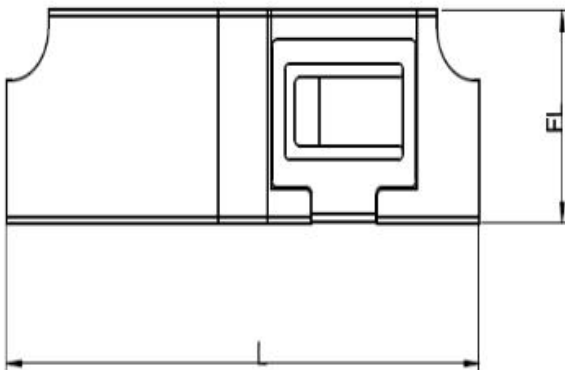
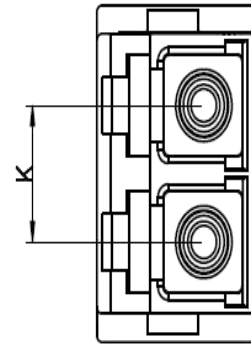
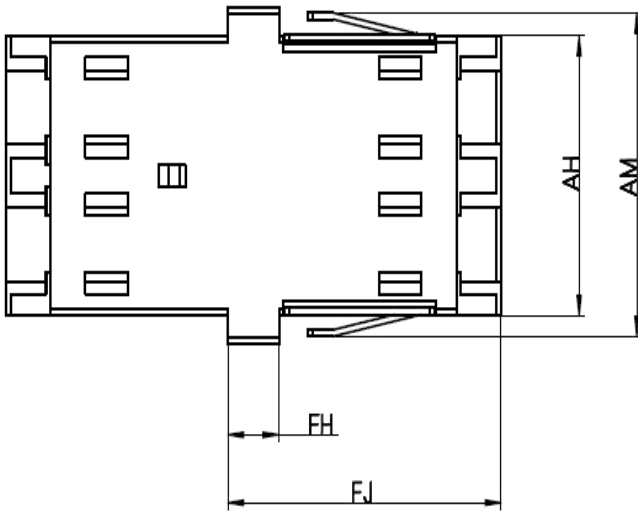

Ref.	Dimensional Tolerance	
	Min	Max
AH	12.6	13
AM	14.4	16.4
FJ	15.95	16.6
K	6.2	6.3
FB	9.2	9.5
FH	2.8	3.2
L	28.5	29.5

With Flange

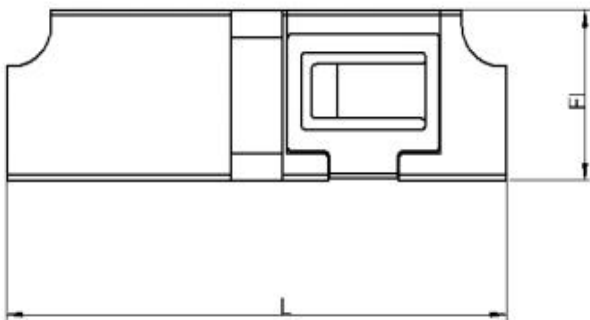
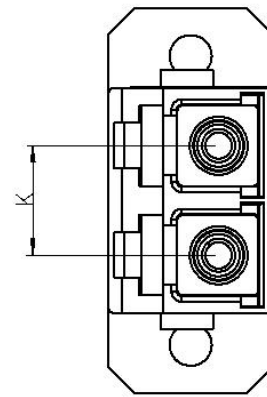
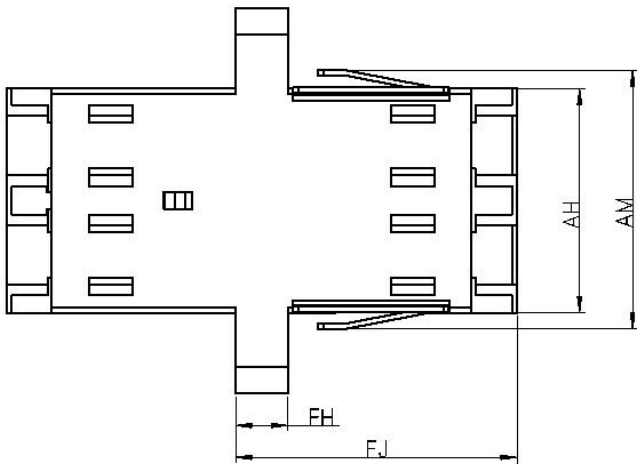

Ref.	Dimensional Tolerance	
	Min	Max
AH	12.6	13
AM	14.4	16.4
FJ	15.95	16.6
K	6.2	6.3
FB	9.2	9.5
FH	2.8	3.2
L	28.5	29.5

Packing:

Inner packing: 50 pcs/Tray

Outer packing: 3000 pcs/Carton

Carton size: 47*30*31mm

Noted:Packing can be customized for you.

For more information please contact us: sales@jiaweice.com